

Approved

Commissioners Court

APR 9 2018

<u>REQUEST FOR AGENDA PLACEMENT FORM</u> Submission Deadline - Tuesday, 12:00 PM before Court Dates	
SUBMITTED BY: David Disheroon TODAY'S DATE: 03/29/2018	
<u>DEPARTMENT:</u>	<u>Public Works</u>
<u>SIGNATURE OF DEPARTMENT HEAD:</u>	_____
<u>REQUESTED AGENDA DATE:</u>	<u>04/09/2018</u>
<u>SPECIFIC AGENDA WORDING:</u> Consideration of variance for two structures on one septic located at 1012 Cashew Drive, Venus, located in Precint 3.	
<u>PERSON(S) TO PRESENT ITEM:</u> David Disheroon	
SUPPORT MATERIAL: (Must enclose supporting documentation)	
TIME: 10 minutes (Anticipated number of minutes needed to discuss item)	ACTION ITEM: <u> X </u> WORKSHOP: _____ CONSENT: _____ EXECUTIVE: _____
<u>STAFF NOTICE:</u>	
COUNTY ATTORNEY: <u> X </u>	IT DEPARTMENT: _____
AUDITOR: _____	PURCHASING DEPARTMENT: _____
PERSONNEL: _____	PUBLIC WORKS: <u> X </u>
BUDGET COORDINATOR: _____	OTHER: _____
*****This Section to be Completed by County Judge's Office*****	
ASSIGNED AGENDA DATE: _____	
REQUEST RECEIVED BY COUNTY JUDGE'S OFFICE _____	
COURT MEMBER APPROVAL _____	Date _____

E-MAILED MAR 29 2018



Variance Request for Septic System

Johnson County Subdivision Rules and Regulations state only one septic system per one (1) acre, Section VII A. Variance fee is \$100 per request. To request a variance for the purpose of:

_____ installing a septic system on a lot or tract of less than an acre or

two residences structures on one (1) septic system or

_____ installing a second septic system on a lot less than 2 acres

Please provide the following information. This request will be presented to the Commissioner's Court for their decision.

Owner Ronald Erbst Date 3/29/18

Phone no. 817-715-6366

Email address RERBSTE@Aol.com

Property Information for Variance Request:

Property 911 address 1012 Caskew dr.

Subdivision name Venus Ridge Block S Lot 4

Survey _____ Abstract _____ Acreage _____

Size of existing residence: 2700 sq. ft.

Does this lot currently have a septic system? Yes No System type ~~ANA~~ AEROBIC

ETJ: Yes - City Venus No

Is a part of the property located in a FEMA designated Floodplain? Yes No

Reason for request Adding Toilet & Sink To NEW Building

Provide the following with this request:

- Copy of your plat if property has been platted
- Copy of property deed
- Survey or drawing showing existing home, buildings, existing & proposed septic system locations



JOHNSON COUNTY PUBLIC WORKS

2 North Mill Street/Suite 305, Cleburne, TX 76033
development@johnsoncountytexas.org (817) 556-6380

Application for 'Authorization to Construct' OSSF System

Office use only

Precinct _____

Authorization to Construct Permit # _____ Firm Panel _____

This is to certify that: _____ has paid a fee of:

\$475.00 Aerobic Septic Systems \$375.00 All other Septic Systems

and has complied with the rules and regulations of this department for the construction of a private liquid waste disposal system - address and owner listed below.

Inspector approval: _____ Date 3 29. 18

This AUTHORIZATION TO CONSTRUCT is only valid with INSPECTOR APPROVAL and is valid for 1 year from the issue date unless revoked for non-compliance with the rules and regulations of this department

To be completed and signed by Property owner or authorized representative

Property Owner's Name: Ronald Erbst Phone number: 817-715-6366

911 site address: 1012 Cakew dr. VENUS, TX. 76084

Current mailing address: 1012 Cakew dr. VENUS, TX. 76084

Please attach verification of legal description such as a copy of: Deed and Survey or other documentation

Legal Description: Metes and Bounds Acreage: _____

Recorded deed: Volume _____ Page _____ Survey _____ Abstract _____

-OR- Subdivision: VENUS RIDGE Lot #: 4 Blk #: 5 Phase / Section #: _____

Well Water or Water provider mountain peak

Is this Building: choose one New ^{SHOP} or Existing

choose one Site Built or Manufactured/Mobile Home Building Square Feet: 2400

choose one Single Family # Bedrooms n/a or Multi-Family # Bedrooms n/a

Commercial # Employees n/a

I certify that the above statements are true and correct to the best of my knowledge. Authorization is hereby given for Johnson County Public Works to enter upon the above described property for the purpose of site evaluation and investigation of an on-site sewage facility.

R. Erbst _____ Date 3/13/18

(Signature of Owner or Representative) (Date)

Site Evaluator: DOYLE CUIA License No. 6470

Phone No: 817-297-2342 Other No. _____

Mailing Address: PO 986 City Crowley State TX Zip 76036

Installer: Ronald Erbst License No. _____

Phone No: 817-715-6366 Other No. _____

Mailing Address: 1012 Cakew dr. City VENUS State TX Zip 76084

****System must be installed according to specifications on attached design****



JOHNSON COUNTY PUBLIC WORKS
 2 North Mill Street/Suite 305, Cleburne, TX 76033
 development@johnsoncountytexas.org (817) 556-6380

ON-SITE SEWAGE FACILITY TECHNICAL INFORMATION FOR PERMIT

PROFESSIONAL DESIGN REQUIRED: Yes No If Yes, professional design attached: Yes No

Designer Name: Doyle Culp License Type and No. 2949 ES
 Phone No. 817-297-2342 Other or Fax No. _____
 Mailing Address: P0986 City: Cleburne State: TX Zip: 76036

I. TYPE AND SIZE OF PIPING FROM: (Example: 4: SCH 40 PVC)

Stub out to treatment tank: 3" PVC sch 40
 Treatment tank to disposal system: 1/8" Per FOOT

II. DAILY WASTEWATER USAGE RATE: Q= 30 w/s (gallons/day)

Water Saving Devices: Yes No

III. TREATMENT UNIT(S): Septic Tank Aerobic Unit

A. Tank Dimensions: _____ Liquid Depth (bottom of tank to outlet): _____
 Size proposed: 30 gal (gal)* Manufacturer: Hydromatic 218

Material/Model# Existing

Pretreatment Tank: Yes No NA Size: _____ (gal)

Pump/Lift Tank: Yes No NA Size: 78 (gal)

B. OTHER Yes No If yes, please attach description.

IV. DISPOSAL SYSTEM:

Disposal Type: Complete Assembled Sewage Basin

Manufacturer and Model #218 Hydromatic or Similar

Area Proposed: 0 Area Required: existing

V. ADDITIONAL INFORMATION:

NOTE - THIS INFORMATION MUST BE ATTACHED FOR REVIEW TO BE COMPLETED.

A. Soil/Site Evaluation B. Planning materials (If Applicable).

DO NOT BEGIN CONSTRUCTION PRIOR TO OBTAINING AUTHORIZATION TO CONSTRUCT. UNAUTHORIZED CONSTRUCTION CAN RESULT IN CIVIL AND/OR ADMINISTRATIVE PENALTIES.

SIGNATURE OF INSTALLER OR DESIGNER: [Signature] DATE: 5/7/18

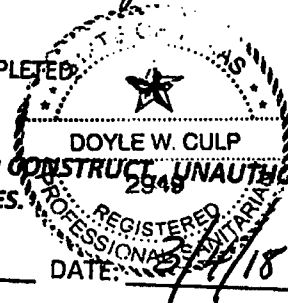



JOHNSON COUNTY PUBLIC WORKS

2 North Mill Street/Suite 305, Cleburne, TX 76033
development@johnsoncountytexas.org (817) 556-6380

ON-SITE SEWAGE FACILITY TECHNICAL INFORMATION FOR PERMIT

PROFESSIONAL DESIGN REQUIRED: Yes No If Yes, professional design attached: Yes No

Designer Name: Doyle Culp License Type and No. 294925

Phone No. 817-297-2342 Other or Fax No. _____

Mailing Address: P0986 City: Cleburne State: TX Zip: 76036

I. TYPE AND SIZE OF PIPING FROM: (Example: 4: SCH 40 PVC)

Stub out to treatment tank: 3" PVC sch 40

Treatment tank to disposal system: 1/8" PVC FOOT

II. DAILY WASTEWATER USAGE RATE: Q= 30 gpd (gallons/day)

Water Saving Devices: Yes No

III. TREATMENT UNIT(S): Septic Tank Aerobic Unit

A. Tank Dimensions: _____ Liquid Depth (bottom of tank to outlet): _____

Size proposed: _____ (gal)* Manufacturer: _____

Material/Model# Existing

Pretreatment Tank: Yes No NA Size: _____ (gal)

Pump/Lift Tank: Yes No NA Size: 78 (gal)

B. OTHER Yes No If yes, please attach description.

IV. DISPOSAL SYSTEM:

Disposal Type: Complete Assembled Sewage Basin

Manufacturer and Model # 218 Hydromatic or Similar

Area Proposed: 0 Area Required: existing

V. ADDITIONAL INFORMATION:

NOTE - THIS INFORMATION MUST BE ATTACHED FOR REVIEW TO BE COMPLETED.

- A. Soil/Site Evaluation
- B. Planning materials (If Applicable).

DO NOT BEGIN CONSTRUCTION PRIOR TO OBTAINING AUTHORIZATION TO CONSTRUCT. UNAUTHORIZED CONSTRUCTION CAN RESULT IN CIVIL AND/OR ADMINISTRATIVE PENALTIES.

SIGNATURE OF INSTALLER OR DESIGNER: [Signature] DATE: 3/14/18

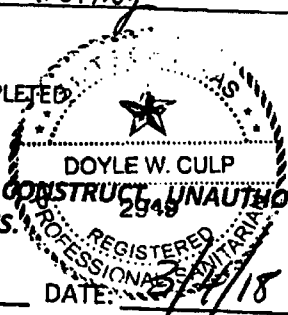

March 4, 2018

DESIGN
COMPLETELY ASSEMBLED SEWAGE BASIN ONLY

PREPARED FOR:

NAME: Ronnie Erbst
ADDRESS: 1012 Cashew Drive Venus, Texas
LEGAL: Johnson County Texas
INSTALLER:

DESIGN PARAMETERS:

ESTIMATED FLOW: 300 Gallon (4 BRm) Water Saving Devices
30 Gallon (Shop) x 2 (People x 15 Gallon)
Total 330 Gallon
LOADING RATE: .064
AREA REQUIRED: 5152 Sq. Ft.
AREA DESIGN: Pre- Existing 5652 Sq. Ft.

SYSTEM PARAMETERS:

GINDER PUMP: Complete Assembled Sewage Package Basin
218 Hydromatic or Similar
PRETREATMENT TANK: Pre-Existing
AERATION TANK: Pre-Existing Aerobic Unit
PUMP TANK: Pre-Existing
SPRINKLER AREA: Pre-Existing Total 5652 Sq. Ft.
PUMP SPECIFICATION: 1/2 H.P.
CHLORINATOR: Yes - 285.91 (4) ANSI / NSF Approved
WATER SUPPLY: Co-Op Water
VEGETATION COVER: Sprayfield areas to be sod in all season grasses

PREPARED BY:

Doyle Culp R.S. 2949
PO Box 986
Crowley, Texas 76036
(817) 297-2342

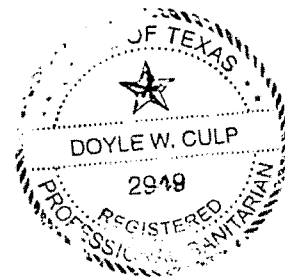

RONNIE ERBAST
1012 CASHEW DR
VENIUS TEXAS

2731 sq Ft
4BRM 300 w/s GALS
Shop 30 w/s GALS
2 people x 15 330 w/s GALS

330 w/s/64 = 5152 sq Ft

Existing 5652 sq Ft

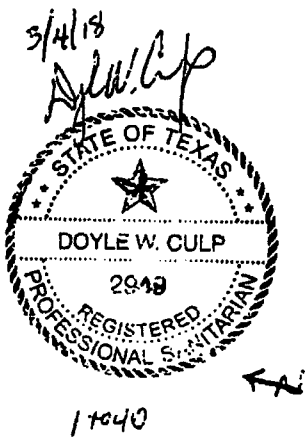
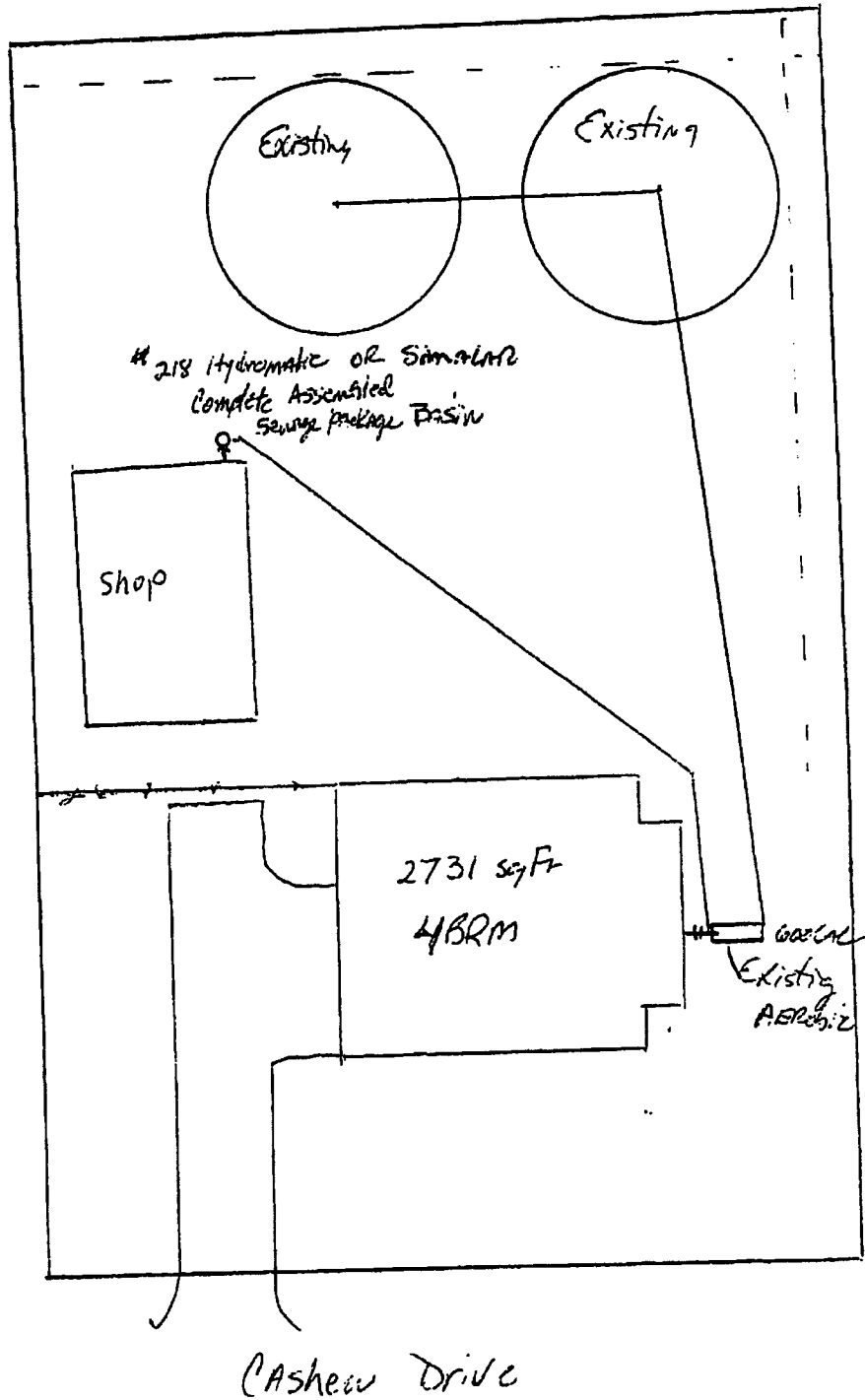

Johnson County Public Works

Johnson County Public Works

1 North Main Street, Suite 305

Cleburne, TX 76033 (817) 556-6380

Receipt Number: 2018-420

3/29/2018 01:48 PM DR 1

Descriptions:

1. \$100.00 Variance Request

2.

3.

4.

Received From:

Ronald Erbst

Amount Received:

\$100.00

Payment Information:

Visa Fee = \$0.00

100166338245

PAID
3-29-18

CC

Mariane request

Signature / Initials: _____

DR 1 3/29/2018 01:48 PM